

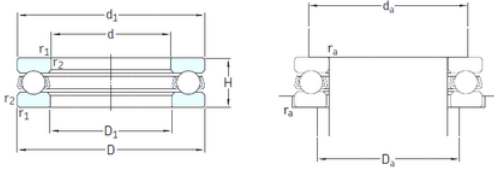

Lokong Bearing Co., Ltd.



22224 Bearing

Bearing No. 51320

51320 Bearing 2D drawings and 3D CAD models

Size	100x170x55 mm
Bore Diameter	100 mm
Outer Diameter	170 mm
Width	55 mm
d	100 mm
D	170 mm
H	55 mm
d1	170 mm
r1 min.	1,5 mm
r2 min.	1,5 mm
D1	103 mm
da min.	142 mm
Da max.	128 mm
ra max.	1,5 mm
Weight	4,95 Kg
Basic dynamic load rating (C)	225 kN
Basic static load rating (C0)	570 kN
Fatigue load limit (Pu)	18,3
Reference speed	1400 r/min
Limiting speed	1900 r/min
Category	Thrust Ball Bearing
Inventory	0.0
Manufacturer Name	SKF
Minimum Buy Quantity	N/A
Weight / Kilogram	5.02
EAN	7316577006974



Lokong Bearing Co., Ltd.

Product Group	B00308
Rolling Element	Ball Bearing
Thrust Bearing	Yes
Single or Double Direction	Single Direction
Banded	No
Cage Material	Steel
Precision Class	ABEC 1 ISO P0
Component Description	Roller Assembly Plus Raceways
Other Features	Single Row
Long Description	100MM Bore 1; 103MM Bore 2; 170MM Outside Diameter; 55MM Height; Ball Bearing; Single Direction; Not Banded; Steel Cage; ABEC 1 ISO P0 Precision
Inch - Metric	Metric
Category	Thrust Ball Bearings
UNSPSC	31171507
Harmonized Tariff Code	8482.10.50.08
Noun	Bearing
Keyword String	Ball Thrust
Manufacturer URL	http://www.skf.com
Manufacturer Item Number	51320
Weight / LBS	11.058
Height	2.165 Inch 55 Millimeter
Overall Height with Aligning Washer	0 Inch 0 Millimeter
Bore 1	3.937 Inch 100 Millimeter
Outside Diameter	6.693 Inch 170 Millimeter
Bore 2	4.055 Inch 103 Millimeter
bore diameter:	100 mm
static load capacity:	570 kN



Lokong Bearing Co., Ltd.

outside diameter:	170 mm
dynamic load capacity:	225 kN
overall width:	55 mm
maximum rpm:	1900 RPM
thrust bearing type:	Single-Direction
cage material:	Steel
outside diameter design:	Straight
fillet radius:	1.5 mm
separable or banded:	Separable
series:	513
precision rating:	ABEC 1 (ISO Class Normal)
d_1	170 mm
D_1	103 mm
$r_{1,2}$ min.	1.5 mm
d_a min.	142 mm
D_a max.	128 mm
r_a max.	1.5 mm
Basic dynamic load rating C	225 kN
Basic static load rating C_0	570 kN
Fatigue load limit P_u	18.3 kN
Minimum load factor A	1.9
Mass bearing (including seat washer where applicable)	4.95 kg